

ROTOLOK

everything under control...



ROTOLOK UK

1 Millennium Place
Tiverton Business Park
Tiverton
Devon
EX16 6SB
United Kingdom

Tel: +44 (0) 1884 232232
Fax: +44 (0) 1884 232200

www.rotolok.co.uk
sales@rotolok.co.uk



NI-HARD WEARBACK & PIPE BENDS

INTRODUCTION

To cope with a whole list of abrasive materials including sand, cement, quarry dust, granite dust, sinter dust, slag, coal and many others which cause extra wear on pipe bends of conventional material, we provide a range of Ni-Hard castings.

Standard radius plain bends with and without replaceable wear-back plates are available. Flanged ends as standard, although special designs can be considered. Ni-Hard bends are essential for the efficient conveying of abrasive materials.

The models with replaceable wearbacks enable the part of the bend most susceptible to wear to be replaced without the need to remove the complete bend from the system. This saves on system down time and keeps the repair cost down.

INSTALLATION

Mating flanges should always be offered up to the Ni-Hard units in a parallel and close fitting position. No undue strain should be imparted on the flanges by pulling up with bolts, as damage to the casting may result.

Due to the issues highlighted above, we recommend that the bends are installed against flat face flanges. If this is not possible, then appropriate spacers / gaskets should be used.

3mm / 1/8" Full Face Rubber gaskets should be used between flanges (flat face).

Maximum torque for bolt tightening should be 67.8 Nm or 50 lb/ft.

NI - HARD WEARBACK BENDS

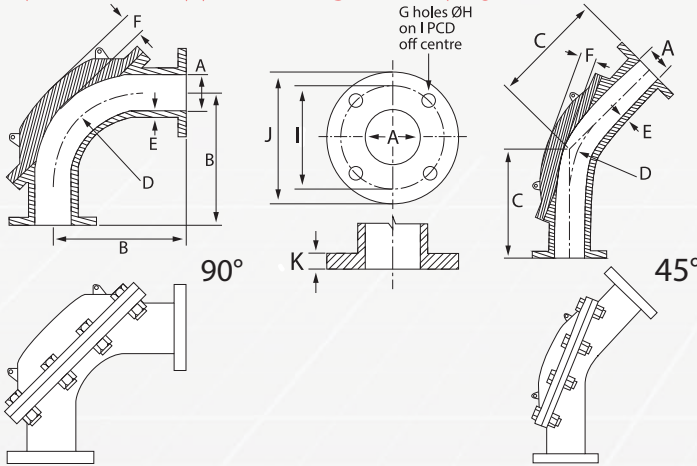

All measurements are in millimetres.

| PIPE I.D. | 90° | | 45° | | RADIUS | WALL | WEARBACK | FLANGE DIMENSIONS (ASA 150) | | | | | WEIGHT (KG) |
|-----------|-----|-----|-----|----|--------|------|----------|-----------------------------|-----|----|-----|---|-------------|
| | A | B | C | D | | | | E | F | G | H | I | |
| 50 | 203 | 203 | 127 | 13 | 40 | 4 | 19 | 121 | 152 | 22 | 24 | | |
| 76 | 320 | 279 | 250 | 16 | 51 | 4 | 19 | 152 | 191 | 20 | 50 | | |
| 102 | 311 | 318 | 210 | 16 | 32 | 8 | 19 | 191 | 229 | 20 | 63 | | |
| 125 | 350 | 287 | 250 | 18 | 51 | 8 | 22 | 216 | 260 | 25 | 80 | | |
| 150 | 300 | 432 | 300 | 18 | 51 | 8 | 22 | 241 | 285 | 22 | 110 | | |
| 200 | 508 | 559 | 406 | 19 | 102 | 8 | 22 | 299 | 343 | 29 | 245 | | |

NI - HARD PLAIN BENDS

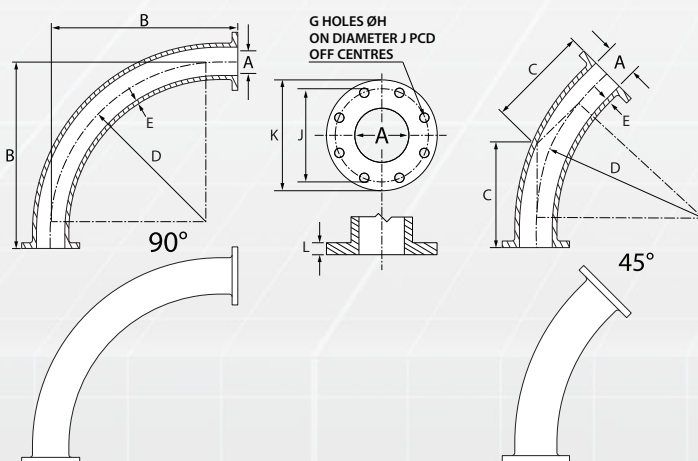

All measurements are in millimetres.

| PIPE I.D. | 90° | | 45° | | RADIUS | WALL | FLANGE DIMENSIONS (ASA 150) | | | | | WEIGHT (KG) | |
|-----------|------|-----|------|----|--------|------|-----------------------------|-----|----|-----|-----|-------------|-----|
| | A | B | C | D | | | E | G | H | J | K | L | 90° |
| 50 | 381 | 203 | 305 | 13 | 4 | 19 | 121 | 152 | 22 | 16 | 11 | | |
| 75 | 533 | 254 | 457 | 16 | 4 | 19 | 152 | 191 | 20 | 39 | 26 | | |
| 100 | 686 | 330 | 610 | 16 | 8 | 19 | 191 | 229 | 20 | 58 | 41 | | |
| 125 | 838 | 381 | 792 | 18 | 8 | 22 | 216 | 260 | 25 | 99 | 54 | | |
| 150 | 991 | 457 | 914 | 18 | 8 | 22 | 241 | 285 | 22 | 135 | 84 | | |
| 200 | 1295 | 584 | 1219 | 19 | 8 | 22 | 299 | 343 | 29 | 234 | 138 | | |
| 250 | 1600 | 711 | 1524 | 20 | 12 | 25 | 362 | 406 | 25 | 342 | 183 | | |